

CL3650R/S



FEATURES

- Legacy product image shown; actual product varies slightly.
- Split Climate™ intelligent cooling system revolutionizes Sub-Zero's already-superior preservation capabilities, keeping food even fresher for longer
- ClearSight™ LED lighting system fully illuminates the interior and reduces shadows
- Sleek stainless accents trim the interior, matching the sophistication of the exterior
- Touch control panel is conveniently located for easy access at the tap of a finger
- Night Mode optimizes the interior lighting based on the detected ambient light, reducing the brightness by 90% in dim environments
- Lift the base of the flip-up dairy compartment to store taller items on the shelf below
- Position adjustable door bins at various heights to accommodate assorted items
- Wi-Fi enabled for convenient remote access using the Sub-Zero Group Owner's App
- Stainless-steel exterior and tubular or pro handles to match other Sub-Zero, Wolf, and Cove products
- Sub-Zero offers an industry-leading full two-year warranty on appliances, along with a full five-year sealed system warranty

ACCESSORIES

- 90° Door Stop
- Air Purification Cartridge
- Custom Front Panel Mounting Kit
- Custom Side Panel Mounting Kit
- Dual Installation Kit
- Egg Container
- Grille Frame - 84"
- Stainless Steel Flush Inset Door Panel with Pro Handle
- Stainless Steel Flush Inset Door Panel with Tubular Handle
- Stainless Steel Pro Louvered Grille - 84"
- Stainless Steel Side Panel
- Dual Installation Kit with Dual Wide Grille
- Stainless Steel Kickplate

Accessories are available through an authorized dealer.  
For local dealer information, visit [subzero-wolf.com/locator](https://subzero-wolf.com/locator).



HANDLE OPTIONS

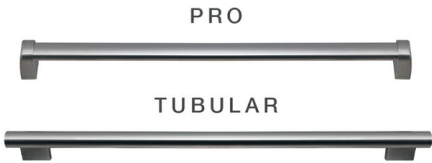

PRODUCT DETAILS

REFRIGERATOR

- 5 glass refrigerator shelves (4 adjustable; 1 stationary)
- 4 crisper drawers with removable dividers
- 5 refrigerator door bins (3 adjustable; 2 stationary)
- 1 flip-up dairy compartment
- Air purification system
- LED refrigerator lights

## DIMENSIONS

Technical drawings of the refrigerator showing front, side, and bottom views with dimensions in inches and millimeters.

**Front View Dimensions:**

- Width: 36" (914)
- Height: 84" (2134)
- Height to top of door: 75 1/4" (1911)

**Side View Dimensions:**

- Depth: 26 3/16" (665)
- Height to top of door: 84" (2134)
- Height to bottom of door: 75 1/4" (1911)
- Height to bottom of base: 4" (102)

**Bottom View Dimensions:**

- Width: 36" (914)
- Depth: 26 3/16" (665)
- Height to top of door: 84" (2134)
- Height to bottom of door: 75 1/4" (1911)
- Height to bottom of base: 4" (102)

**Height Dimensions  $\pm 1/2"$  (13)**

**NOTE:** Dimensions in parenthesis are in millimeters unless otherwise specified

This illustration is intended for interior reference only and may not represent the exterior of the model being specified.

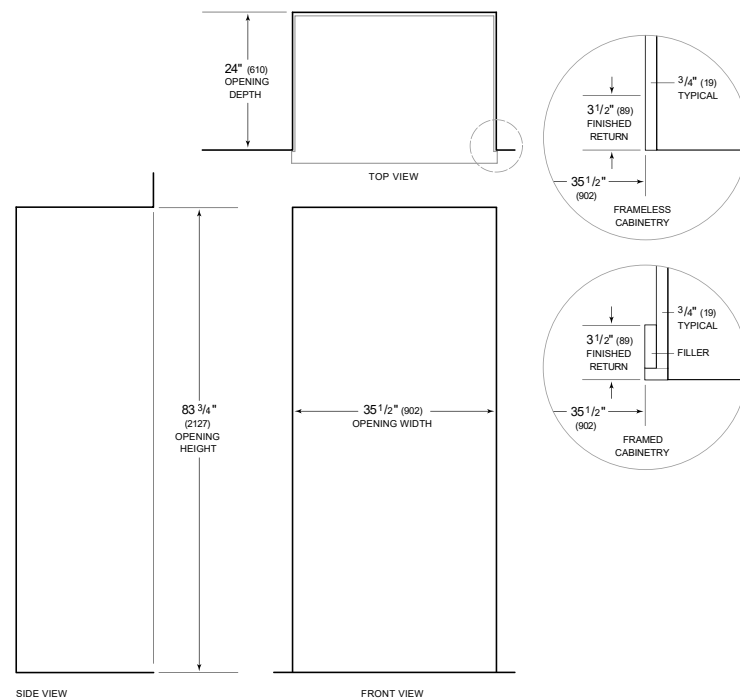

NOTE: 3 1/2" (89) finished returns will be visible and should be finished to match cabinetry  
Shaded line represents profile of unit.