

Quick Start Manual



DR3 Models

 **Speed Queen.**

Welcome

Welcome to the Speed Queen® family. Thank you for your support of our truly commercial quality products. Our washers and dryers are expertly engineered to deliver commercial performance, tested to ensure ultimate durability and built with American Pride. For more than 110 years, Speed Queen consumer laundry products have been manufactured in Ripon, Wisconsin, a place where pride of workmanship is not just alive, but thriving and embodied by each individual who designs, tests, assembles or in some way touches a Speed Queen product. A special thing happens when that pride is combined with the highest quality commercial materials and components...it leads to the ultimate reliability...reliability measured in decades, not years. That's legendary Speed Queen Quality.

Installation

Parts included:



Three (3) Screws
(Electric Models)



Lint Filter Guard
(Optional)

1. Position and level the dryer.
 - Recommended rear clearance minimum is 2 in (51 mm) for utility connections and 6 in (152 mm) when venting through rear of unit
2. Connect exhaust system.
 - Dryer must be exhausted to the outdoors
 - Use 4 in (102 mm) rigid duct
 - Maximum straight duct length = 65 ft (19.8 m). Each elbow deduct 10 ft (3 m)
 - Sufficient make-up air must be supplied. The free area of any opening for outside air must be at least 40 in² (25806 mm²) per unit
3. Gas models – connect gas supply pipe. Gas service to a gas dryer must conform with the local codes and ordinances. *Refer to installation instructions, which can be found at speedqueendoc.net*
 - Tighten all connections securely but do not overtighten to avoid breaking or bending the gas valve bracket.

Turn on gas and check all pipe connections (internal and external) for gas leaks by applying a non-corrosive leak detection fluid to the fittings. If bubbles are present then a leak is likely. Retighten connections and recheck for leaks.
4. Electric models – connect electrical cord with three-wire or four-wire plug. *Refer to installation instructions, which can be found at speedqueendoc.net*
5. Wipe out inside of dryer.
6. Plug in the dryer.
7. Start dryer and check that dryer is heating.

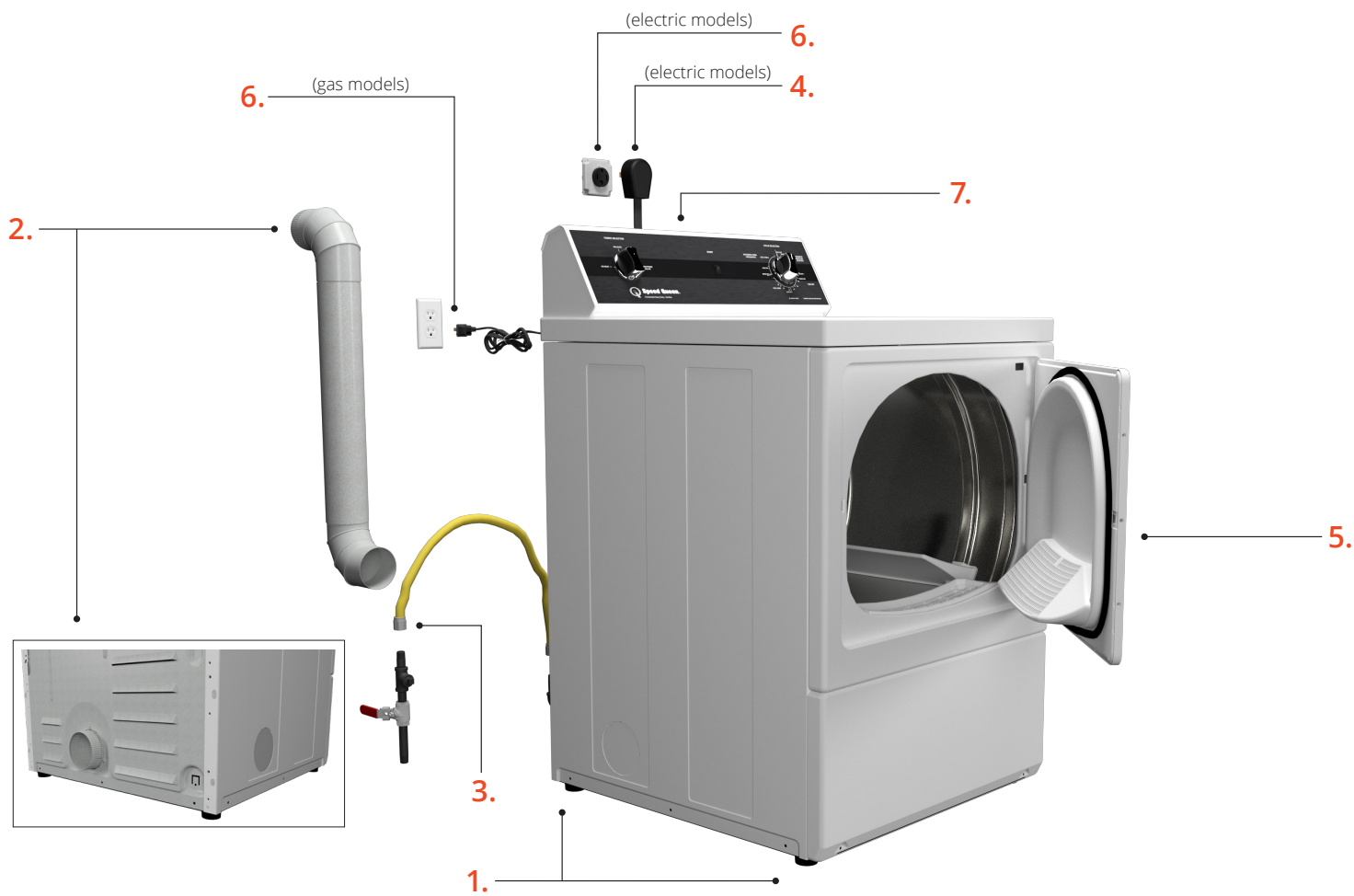

Cycle Information

The following cycle descriptions will help determine which cycle to choose depending on the type of laundry being dried.

Time Dry Cycle

This cycle will operate dryer for up to 75 minutes. Cottons and heavyweight items dry best between 50 and 75 minutes, and lightweight items dry best between 20 and 40 minutes.

Automatic Regular/Delicate Cycle

Use for sturdy items like play or work clothes and also for delicate items. The type of heat is determined by choosing the proper Fabric Selector option. There are three settings in the Automatic Regular/Delicate cycle: Max Dry, More Dry, and Less Dry.

Automatic Perm Press/Knits Cycle

Use for permanent press items and synthetics. The type of heat is determined by selecting the proper Fabric Selector option. There are three settings in the Automatic Perm Press/Knits cycle: More Dry, Less Dry, and Cool Down (select models).

Sanitize*

This is a high heat, 75 minute cycle intended to sanitize medium size loads. Be sure to follow the item manufacturer's fabric care instructions.

Set the Cycle Selection to Time Dry, Max Dry, the Fabric Selector to Perm Press/Regular, and allow the dryer to complete the cycle uninterrupted.

**Bacteria tested by an independent lab were Staphylococcus aureus, Pseudomonas aeruginosa, Klebsiella pneumoniae. Individual results may vary.*



Operating

1. Prepare laundry



2. Clean lint filter by wiping lint out of screen area
(if using lint filter guard, remove first)

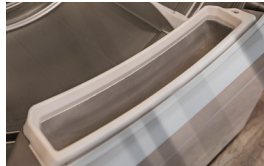

3. Load dryer half full with laundry



4. Close door



5. Set cycle

6. Set temperature or fabric selector

7. Press start button to start

8. Remove laundry from dryer once cycle has ended

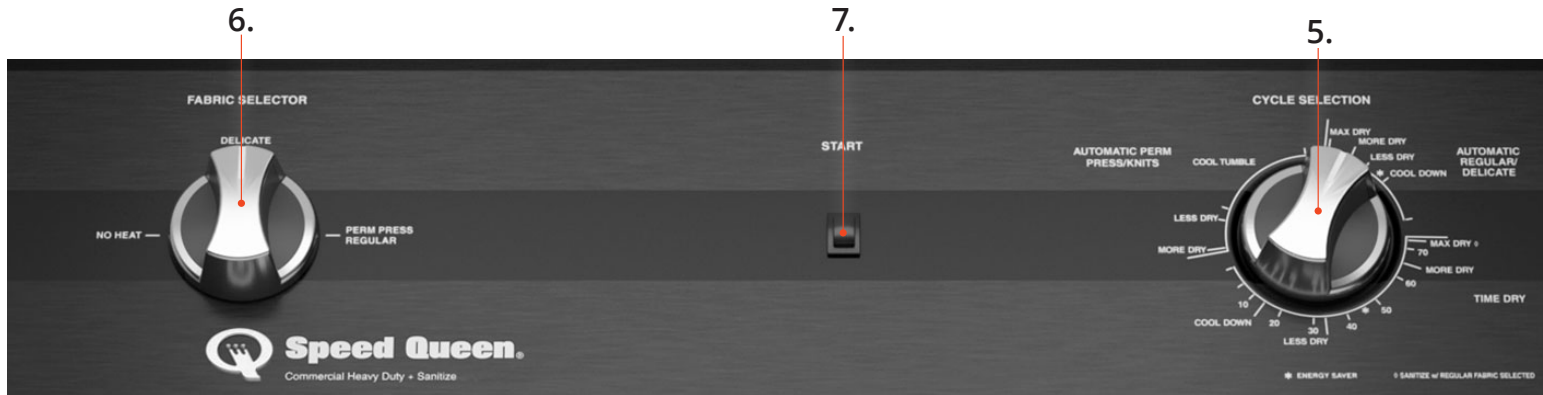

Register

1. Register your product at www.speedqueen.com to take full advantage of the limited warranty.



3, 5 & 7 Year Warranties, depending on your model.
Covers all parts and in-home labor.

Note: This unit includes a limited warranty. Refer to Speedqueendoc.net to download the full warranty bond.

2. Download full documentation and view installation and operating videos for an immersive experience at Speedqueendoc.net or scan the QR code below.

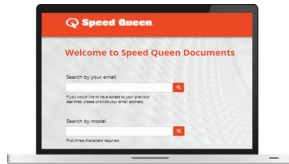

3. If you wish to receive printed documents at no cost, please complete the order form online at speedqueen.com/request-printed-documents/ or email your request to technicalcommunications@alliancels.com.



Order Form for Printed Documentation

- ☐ Please send me a printed Installation Manual, User's Guide, and Warranty Bond.
- ☐ I understand this card does not register my product. I must go to www.speedqueen.com to register.

Model No. _____

Serial No. _____

Name _____

Address _____ City _____ State _____

Zip Code _____ Phone No. _____

Email Address _____

Allow 1-2 weeks for delivery.

NOTE: Orders will be fulfilled for models with serial numbers from 1903000000 through 2312999999.



Part No. D518607R1

March 2025

© Published by permission of the copyright owner – DO NOT COPY or TRANSMIT
Speed Queen by Alliance Laundry Systems



NO POSTAGE
NECESSARY IF
MAILED IN THE
UNITED STATES

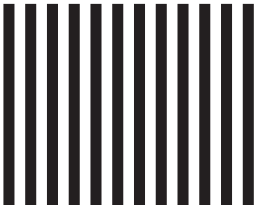

BUSINESS REPLY MAIL

FIRST CLASS MAIL PERMIT NO. 489 RIPON, WI

POSTAGE WILL BE PAID BY ADDRESSEE

SPEED QUEEN
TECHNICAL DOCUMENTATION
SHEPARD STREET
P O BOX 990
RIPON WI 54971-9967

