



Commercial Service Parts

SEALED BURNER (HSB)

Hestan Commercial Corporation
3375 E. La Palma Ave.
Anaheim, CA 92806
(888) 905-7463

RETAIN THIS FOR FUTURE REFERENCE

Revised: May 15, 2020
Rev. B

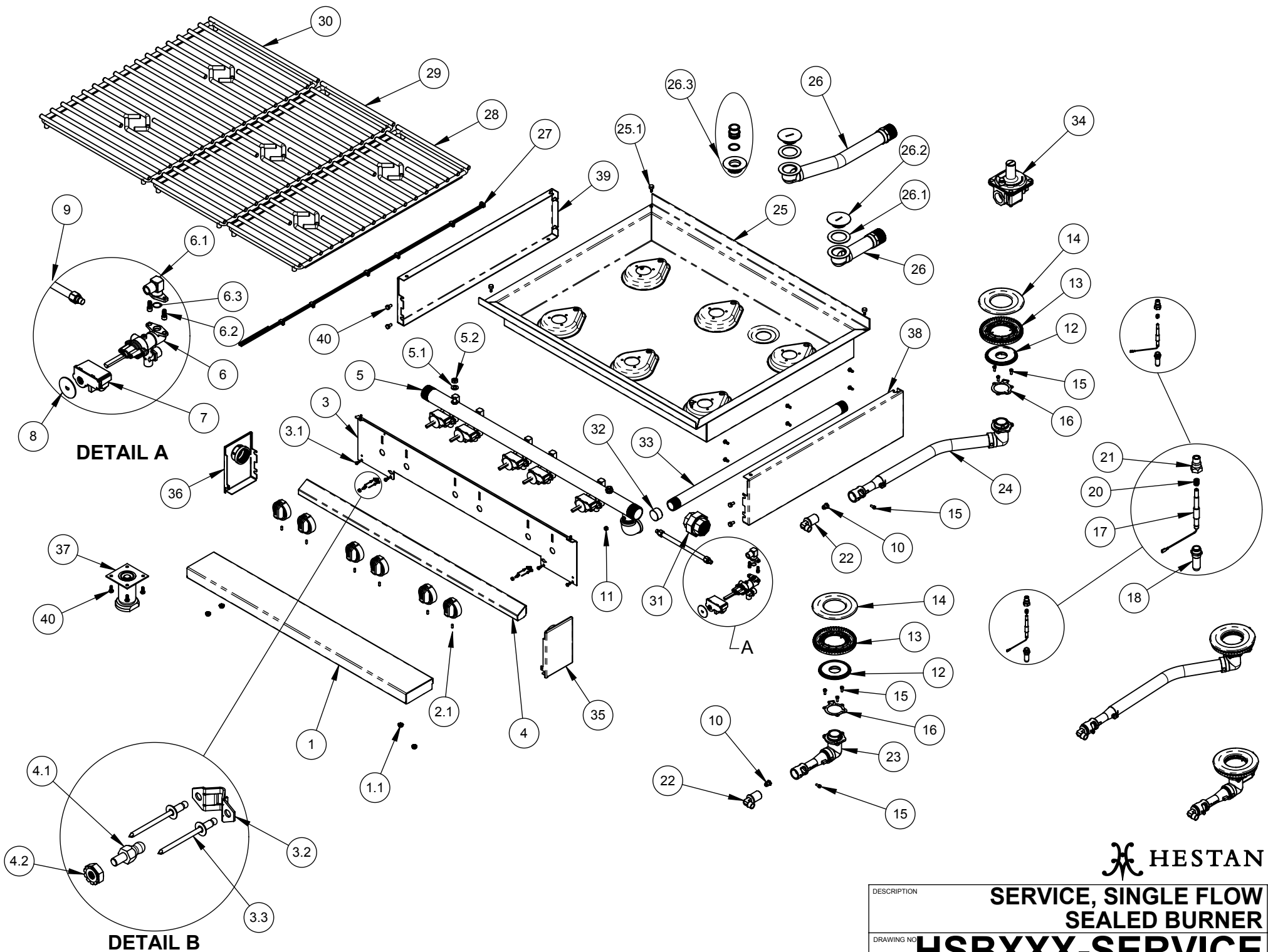

HESTAN

**SERVICE, SINGLE FLOW
SEALED BURNER**

DESCRIPTION

DRAWING NO.

HSBXXX-SERVICE

SERVICE PARTS, Open Burner, Mixed W/Spark Ign., Wiring Diagram

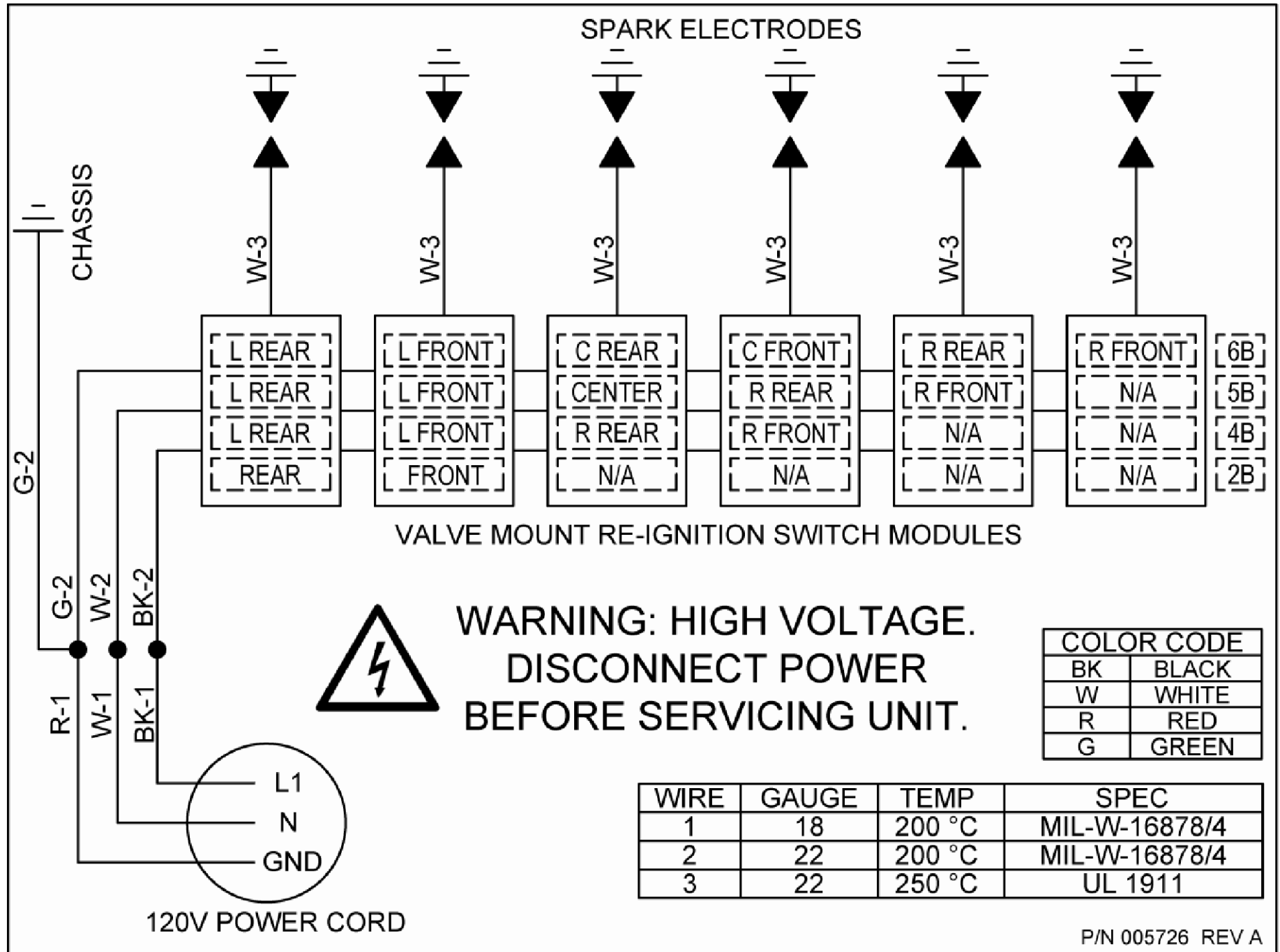

SEALED BURNER: SINGLE FLOW - SERVICE PARTS LIST

Item No.	Part No.	DESCRIPTION	HSB122	HSB182	HSB244	HSB364	HSB365	HSB366
			QTY	QTY	QTY	QTY	QTY	QTY
1	003659	PLATE SHELF, 12, W/A	1	-	-	-	-	-
	003660	PLATE SHELF, 18, W/A	-	1	-	-	-	-
	003662	PLATE SHELF, 24, W/A	-	-	1	-	-	-
	003664	PLATE SHELF, 36, W/A	-	-	-	1	1	1
	018046	PLATE SHELF, 6" EXTENDED, WA, 12	1	-	-	-	-	-
	034423	PLATE SHELF, 6" EXTENDED, WA, 18	-	1	-	-	-	-
	034424	PLATE SHELF, 6" EXTENDED, WA, 24	-	-	1	-	-	-
	006053	PLATE SHELF, 6" EXTENDED, WA, 36	-	-	-	1	1	1
	034428	PLATE SHELF, 8" EXTENDED, WA, 12	1	-	-	-	-	-
	034427	PLATE SHELF, 8" EXTENDED, WA, 18	-	1	-	-	-	-
	034426	PLATE SHELF, 8" EXTENDED, WA, 24	-	-	1	-	-	-
006069	PLATE SHELF, 8" EXTENDED, WA, 36	-	-	-	1	1	1	
1.1	012685	SERVICE, NUT, LOCK, SERRATED FLANGE, 1/4-20, PKG 4	1	1	1	1	1	1
2	001336	KNOB ASSY., SEALED BURNER, 100%	2	2	4	4	5	6
2.1	014301	SERVICE, SETSCREW, #10-24 X .875, CONE PT., SS, PKG 6	1	1	1	1	1	1
3	004742	PANEL, CONTROL, SEALED BURNER, 12 - INDICATOR	1	-	-	-	-	-
	004716	PANEL, CONTROL, SEALED BURNER, 18 - INDICATOR	-	1	-	-	-	-
	004648	PANEL, CONTROL, SEALED BURNER, 24 - INDICATOR	-	-	1	-	-	-
	004238	PANEL, CONTROL, SEALED BURNER, 364 - INDICATOR	-	-	-	1	-	-
	004237	PANEL, CONTROL, SEALED BURNER, 365 - INDICATOR	-	-	-	-	1	-
	004236	PANEL, CONTROL, SEALED BURNER, 366 - INDICATOR	-	-	-	-	-	1
3.1	012672	SERVICE, SMS, 10-24 X 1/2, PH, PAN, TYPE F, SS, PKG 4	2	2	2	2	2	1
3.2	012752	RECEPTACLE, BALL STUD, 18LB PULL, PKG 4	1	1	1	1	1	1
3.3	012751	POP RIVET, CSINK, 1/8DIA X .275L, SS, PKG 8	1	1	1	1	1	1
4	001410	CHIN, CONTROL PANEL, W/O HANDLE, 12" WA.	1	-	-	-	-	-
	001408	CHIN, CONTROL PANEL, W/O HANDLE, 18" WA.	-	1	-	-	-	-
	001582	CHIN, CONTROL PANEL, W/O HANDLE, 24" WA.	-	-	1	-	-	-
	001194	CHIN, CONTROL PANEL, W/O HANDLE, 36" WA.	-	-	-	1	1	1
4.1	012687	BALL STUD, MALE, 6-32UNC, .052-.078 PNT THK, P116-447-8-3B, PKG 4	1	1	1	1	1	1
4.2	012688	SERVICE, NUT, KEPS, 6-32, SS, PKG 4	1	1	1	1	1	1
5	001562	MANIFOLD, SEALED BURNER, 12-2, WA	1	-	-	-	-	-
	004713	MANIFOLD, SEALED BURNER, 18-2, WA	-	1	-	-	-	-
	004650	MANIFOLD, SEALED BURNER, 24-4, WA	-	-	1	-	-	-
	003897	MANIFOLD, SEALED BURNER, 36-4, WA	-	-	-	1	-	-
	001896	MANIFOLD, SEALED BURNER, 36-5, WA	-	-	-	-	1	-
	000257	MANIFOLD, SEALED BURNER, 36-6, WA	-	-	-	-	-	1
5.1	012679	SERVICE, WSH, FLAT, 3/8 SAE, PKG 4	1	1	1	1	1	1

Item No.	Part No.	DESCRIPTION	HSB122	HSB182	HSB244	HSB364	HSB365	HSB366
			QTY	QTY	QTY	QTY	QTY	QTY
5.2	012681	SERVICE, NUT, 3/8-16 X .25 HT, ZN, PKG 4	1	1	1	1	1	1
6	004922	VALVE, SINGLE FLOW, SEALED BURNER, ASSY.	2	2	4	4	5	6
6.1	002207	ELBOW, FLANGE, VALVE, SEALD BURNER ASSY.	1	1	1	1	1	1
6.2	014650	SERVICE, SHCS, 12-24 X .5, SS, PKG 6	1	1	1	1	1	1
6.3	014646	SERVICE, O-RING, SILICONE, 11.5MM IDX1.5MM THK, PKG 6	1	1	1	1	1	1
7	000530	MODULE, EGO RE-IGNITER, SINGLE POINT, IRIS COOKTOP, 120V/60Hz/5mA	2	2	4	4	5	6
8	004029	SHIELD, SWITCH/MODULE	2	2	4	4	5	6
9	005682	HOSE, FLEX, 3/8 OD, 12" F-F, NUT/FERRULE	2	2	4	4	5	6
10	002039	ORIFICE, #42, MAIN, SEALED BURNER, SF-NG	2	2	4	4	5	6
	004925	ORIFICE, #54, MAIN, SEALED BURNER, SF-LP	2	2	4	4	5	6
11	000360	PLUG, HEX SOCKET, 1/8" NPT	1	1	1	1	1	1
12	002057	BURNER BASE, SEALED BURNER SF	2	2	4	4	5	6
13	002055	HEAD, BURNER, SEALED BURNER, SF	2	2	4	4	5	6
14	002058	BURNER RING, SEALED BURNER, SF	2	2	4	4	5	6
15	014390	SERVICE, SCREW, MOUNTING, M5X12, PKG 4	1	1	1	1	2	2
16	002056	GASKET, MAIN, SEALED BURNER, SF	2	2	4	4	5	6
17	005013	IGNITER ASSY, SEALED BURNER, SF	2	2	4	4	5	6
18	002037	SHAFT, IGNITER, SEALED BURNER, SF	2	2	4	4	5	6
19	014191	SERVICE, HB, 1/4-20 X .625, SS, PKG 4	4	4	4	4	4	4
20	014673	SERVICE, SPRING, IGNITER, SEALED BURNER, DF, PKG 4	1	1	1	1	2	2
21	002038	NUT IGNITER, SEALED BURNER, SF	2	2	4	4	5	6
22	002048	JET HOLDER, MAIN, SEALED BURNER, SF/DF	2	2	4	4	5	6
23	010662	ELBOW, SINGLE BURNER, FRONT, ASSY.	1	1	2	2	3	3
24	002034	ELBOW, SINGLE BURNER, ASSY.	1	1	2	2	3	3
25	011912	BOWL, SEALED BURNER, ALL SINGLE, 12"-2, WELD NUT, WA	1	-	-	-	-	-
	011904	BOWL, SEALED BURNER, ALL SINGLE, 18"-2, WELD NUT, WA	-	1	-	-	-	-
	011902	BOWL, SEALED BURNER, ALL SINGLE, 24"-4, WELD NUT, WA	-	-	1	-	-	-
	011896	BOWL, SEALED BURNER, ALL SINGLE, 36"-4, WELD NUT, WA	-	-	-	1	-	-
	011868	BOWL, SEALED BURNER, ALL SINGLE, 36"-5, WELD NUT, WA	-	-	-	-	1	-
	011863	BOWL, SEALED BURNER, ALL SINGLE, 36"-6, WELD NUT, WA	-	-	-	-	-	1
	016712	BOWL, SEALED BURNER, ALL SINGLE, 12"-2, WLD NUT, WA, LP	1	-	-	-	-	-
	016713	BOWL, SEALED BURNER, ALL SINGLE, 18"-2, WLD NUT, WA, LP	-	1	-	-	-	-
	016827	BOWL, SEALED BURNER, ALL SINGLE, 24"-4, WLD NUT, WA, LP	-	-	1	-	-	-
	018226	BOWL, SEALED BURNER, ALL SINGLE, 36"-4, WELD NUT, WA, LP	-	-	-	1	-	-
018224	BOWL, SEALED BURNER, ALL SINGLE, 36"-5, WELD NUT, WA, LP	-	-	-	-	1	-	
018227	BOWL, SEALED BURNER, ALL SINGLE, 36"-6, WELD NUT, WA, LP	-	-	-	-	-	1	
25.1	014376	SERVICE, SCREW COVER, SEALED BURNER, WA, PKG 6	1	1	1	1	1	1
26	001047	DRAIN, 1 1/2", SEALED BURNER, ASSY.	-	1	1	1	1	1
	004747	DRAIN, 1 1/2", SEALED BURNER, 12" ASSY.	1	-	-	-	-	-
26.1	001041	WASHER, DRAIN, SEALED BURNER	1	1	1	1	1	1
26.2	001037	PLUG, DRAIN, SEALED BURNER	1	1	1	1	1	1

Item No.	Part No.	DESCRIPTION	HSB122	HSB182	HSB244	HSB364	HSB365	HSB366
			QTY	QTY	QTY	QTY	QTY	QTY
26.3	001262	PLUG, DRAIN, OVERFLOW, SEALED BURNER	1	1	1	1	1	1
	001291	O-RING, SIZE 214, SILICONE, OVERFLOW DRAIN PLUG	1	1	1	1	1	1
	001329	STRAINER, CUSTOM, DRAIN, SEALED BURNER	1	1	1	1	1	1
27	014158	SERVICE, HARNESS, WIRE, SEALED BURNER, 18-2	1	1	-	-	-	-
	014162	SERVICE, HARNESS, WIRE, SEALED BURNER, 36-4	-	-	1	1	-	-
	014169	SERVICE, HARNESS, WIRE, SEALED BURNER, 36-5	-	-	-	-	1	-
	014171	SERVICE, HARNESS, WIRE, SEALED BURNER, 36-6	-	-	-	-	-	1
28	001290	GRATE, SEALED BURNER, COMBO, 12" ASSY.	1	-	2	-	2	3
29	004332	GRATE, SEALED BURNER, COMBO, 5 BURNER, ASSY.	-	-	-	-	1	-
30	004333	GRATE, SEALED BURNER, COMBO, 18" ASSY.	-	1	-	2	-	-
31	000254	UNION, 1.25" NPT - 5P594	1	1	1	1	1	1
32	000258	PLUG, SQUARE SOCKET, 1" NPT	1	1	1	1	1	1
33	AHRGC	REAR GAS CONNECTION, 1" NPT	1	1	1	1	1	1
34	004163	REGULATOR, STRAIGHT-THRU, 1"NPT, NG	1	1	1	1	1	1
	004162	REGULATOR, STRAIGHT-THRU, 1"NPT, LP	1	1	1	1	1	1
	004165	REGULATOR, STRAIGHT-THRU, 1-1/4"NPT, NG	1	1	1	1	1	1
	004164	REGULATOR, STRAIGHT-THRU, 1-1/4"NPT, LP	1	1	1	1	1	1
35	AHCCR	CAP, MANIFOLD, RIGHT, ASSY	1	1	1	1	1	1
36	AHCCL	CAP, MANIFOLD, LEFT, ASSY	1	1	1	1	1	1
37	000470	ADJUSTABLE LEG, ASSY, 4"	4	4	4	4	4	4
38	000122	PANEL, SIDE, RH, RANGETOP	1	1	1	1	1	1
39	000501	PANEL, SIDE, LH, RANGETOP	1	1	1	1	1	1
40	013303	SERVICE, HB, 1/4-20 X .5, ZN, PKG 8	1	1	1	1	1	1