

CFZ455: Freezer, Reach-In



CFZ455

Features and Specifications

Volume of 48 cu ft comfortably fits 18" x 26" sheet pans
AISI 441 stainless steel interior and exterior with locks
Temperature range: -13°F to 14°F
Electronic digital temperature control with alarms
Autodefrost
High efficiency compressor, top mount, with 9.6 running amps
High efficiency evaporator coil & condenser
Self-lubricating, sealed cast iron evaporator fan motor with high volume airflow design
CFC-free high-density polyurethane insulated cabinet
Factory pre-wired for dedicated outlet, 11 ft cord and plug included NEMA 5-15P
Environmentally friendly R290 refrigerant - 4.2 oz (0.120kg)
2 sections, includes 6 epoxy coated wire shelves
Dimensions: 80 23/32" H x 55 1/8" W x 31 1/2" D
4 adjustable legs

Model Details

Model	Description	Voltage/Hz/Phase	Shipping Weight
UCFZ455-SS71A	Freezer, Reach-In	115v / 60hz / 1	418 lb

Accessories

Model	Description	Shipping Weight
ULA4080584	Shelf Guide	.88 lb
ULAQ32-0002	Epoxy Coated Wire Shelf (20.86" x 25.6")	2.2 lb
ULA89030400	Adjustable Leg kit	11.02 lb
ULA81040300	Caster Kit	11.02 lb
ULA80010380	Door Lock Kit	2.2 lb
ULA80110300	Light Kit	2.2 lb



Product Specifications • 48 cu ft Freezer, Reach-In

Front (Open)

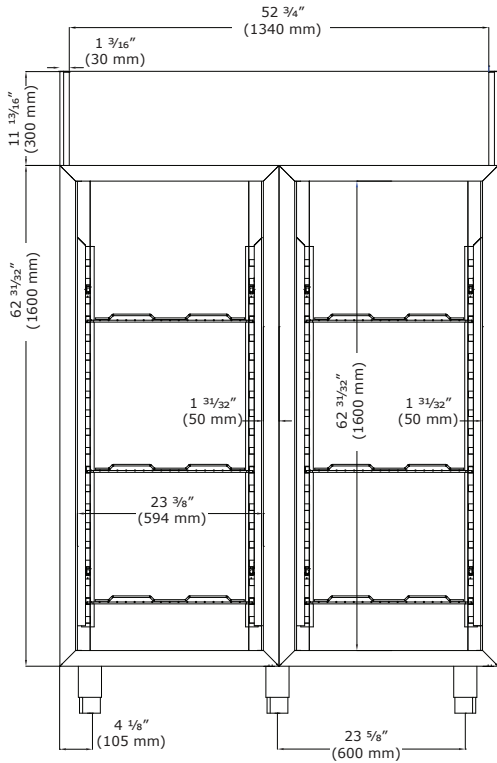

Front (Closed)

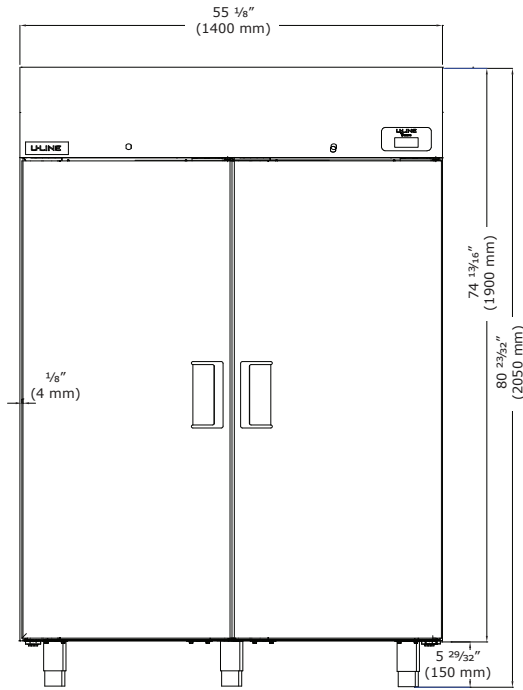

Top

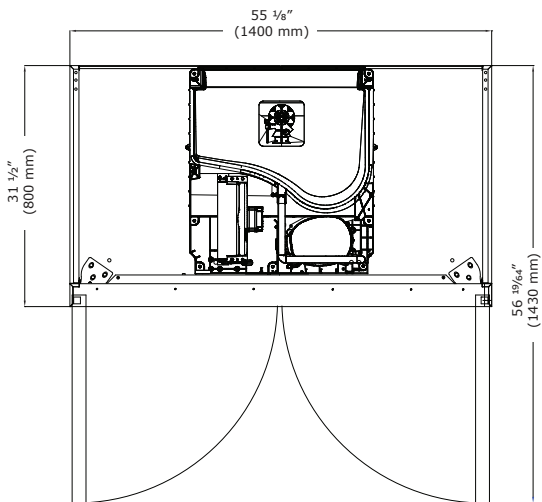

Side

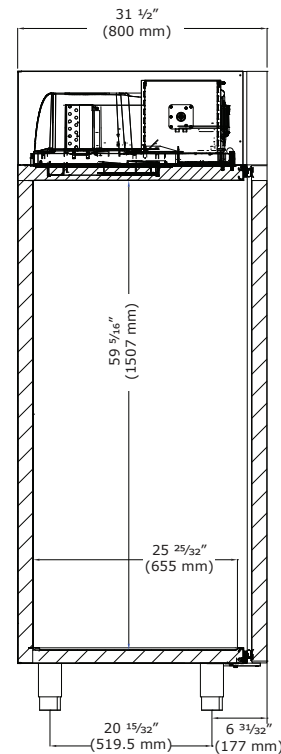

Commercial Warranty

1 Year (parts & labor) / 5 year sealed system (parts)
See complete warranty for details

